

220, 323 & 320D WHEELED DINGOS



BIG BENEFITS IN SMALL SPACES

GO WHERE YOU NEED TO WORK.

Access confined spaces you never thought possible with a wheeled Dingo® compact utility loader. These models offer zero-turn capability, along with a shorter length that's easy to load on a trailer. You also get reliable hydraulic power to use a wide range of attachments. If you do a lot of tasks in tight spaces or on hard surfaces, these are the models for you.

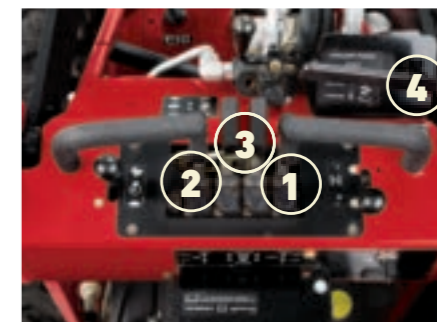

DINGO CONTROLS

Responsive controls make the wheeled Dingo highly maneuverable:

- 1 Curl or dump the attachment while raising or lowering the loader arms.
- 2 Raise and lower loader arms.
- 3 Traction drive control.
- 4 Activate the auxiliary circuit control lever to power the attachments instantly.



220, 323 & 320D FEATURES



HIGHLY MANEUVERABLE
Short wheelbase design offers excellent maneuverability. Get into tight spaces where only hand labor could go before.

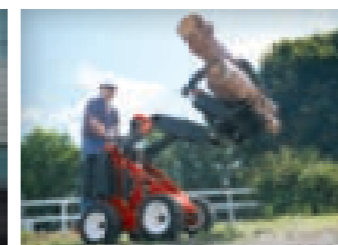

TWO TRANSPORT SPEEDS
Low speed sends more hydraulic power to the attachment and high speed sends more power to the wheels. The low speed option also helps new operators shorten their learning curve.



IMPROVED VISIBILITY
The integrated ride-on operator platform allows improved visibility of the working area and attachments.



4-PAW™ INDEPENDENT FOUR-WHEEL DRIVE
Four independent wheel motors deliver hydraulic flow and pressure to all four wheels for improved traction and mobility. Fewer moving parts also mean less maintenance.
Available on 323 and 320D only.

220, 323 & 320D

MEET THE FAMILY



DINGO TX 1000 SPECIFICATIONS

	DINGO TX 1000 NARROW TRACK 22327	DINGO TX 1000 WIDE TRACK 22328
DIMENSIONS A		
Wheelbase	41" (10 cm)	
Ground Clearance	6.0" (15 cm)	
Overall Width	33.7" (86 cm)	41" (104 cm)
Overall Length	100.7" (256 cm) w/bucket; 81.7" (208 cm) w/o bucket	
Overall Height	53.2" (135 cm)	
Max Operating Height	105" (267 cm)	
Hinge Pin Height	81" (206 cm)	
Dump Height	61" (155 cm)	
Dump Angle	40-degrees	
Reach - Fully Raised	24.5" (62 cm)	
Ground Speed (F/R)	4.7 mph (7.6 km/h) / 4.7 mph (7.6 km/h)	
Weight	2,610 lbs (1184 kg)	2,790 lbs (1266 kg)
Tip Capacity	2,857 lbs (1,296 kg)	3,071 lbs (1,393 kg)
Rated Operating Capacity (35% of Tip Capacity)*	1,000 lbs (454 kg)	1,075 lbs (488 kg)
ENGINE		
Engine	Kubota® D1305	
Manufacturer's Gross HP Rating at RPM**	24.9 HP (18.6 kW) @ 2600 rpm	
Displacement	77 cu. in. (1262cc)	
Fuel Type	Diesel	
Air Filter	Two-stage, heavy-duty, remote	
Cooling System	Liquid Cooled	
Fuel Tank	11.5 gallons (44 liters)	
Oil Capacity	6.0 quarts (5.7 liters)	
Loader Arms	Vertical	
OPERATION		
Hydraulic Pressure	3,000 PSI	
Hydraulic Flow	Traction: 13.3 gpm (each pump); Auxiliary: 15.2 gpm	
Reservoir Capacity	10 gallons (57.5 liters)	
TRACKS		
Tracks	Sprocket-drive, 6 road wheels per side	
Traction	Dual hydrostatic pump	
Track Length x Width	127.6" x 5.9" (324 cm x 15 cm)	127.6" x 9.5" (324 cm x 24 cm)
Ground Pressure	5.4 PSI	3.6 PSI

* Per ISO 14397-1
** Per SAE 1995

DINGO TX 427 & TX 525 SPECIFICATIONS

	TX 525 22323	TX 525 WIDE 22324	TX 427 22321	TX 427 WIDE 22322
A Wheelbase	31.2" (79 cm)		31.2" (79 cm)	
B Ground Clearance	4.6" (11.7 cm)			
Overall Width	33.7" (85.6 cm)	41" (104 cm)	33.7" (85.6 cm)	41" (104 cm)
C Overall Length	92" (233.7 cm) w/bucket; 70.7" (180 cm) w/o bucket		92" (233.7 cm) w/bucket; 70.7" (180 cm) w/o bucket	
D Overall Height	46.1" (117.1 cm)			
E Max Operating Height	90.1" (229 cm)			
F Hinge Pin Height	65.8" (167.1 cm)			
G Dump Height	46.1" (117.1 cm)			
H Dump Angle	38-degrees			
I Reach - Fully Raised	21.8" (55.4 cm)			
Ground Speed (F/R)	0-4.5 mph (0-7.2 km/h) / 0-2.0 mph (0-3.2 km/h)		0-4.5 mph (0-7.2 km/h) / 0-2.0 mph (0-3.2 km/h)	
Weight	1,904 lbs (864 kg)	2,013 lbs (907 kg)	1,882 lbs (854 kg)	1,990 lbs (902 kg)
Tip Capacity	1,580 lbs. (717 kg)		1,530 lbs. (694 kg)	
Rated Operating Capacity (35% of Tip Capacity)*	553 lbs. (251 kg)		535 lbs. (243 kg)	
Engine	Kubota D902		Kohler Command Pro Series CH 740	
Manufacturer's Gross HP Rating at RPM**	23.3 HP (17.3 kW) @ 3400 rpm		25 HP (20.1 kW) @ 3600 rpm	
Displacement	55 cu. in. (901cc)		44 cu. in. (725cc)	
Fuel Type	Diesel		Gas	
Air Filter	Two-stage, heavy-duty, remote		Two-stage, heavy-duty, remote	
Cooling System	Liquid Cooled		Air Cooled	
Fuel Tank	6.0 gallons (23 liters)		6.0 gallons (23 liters)	
Oil Capacity	3.84 quarts (3.63 liters) 2.0 quarts (2.95 liters)		2.0 quarts (2.95 liters)	
Loader Arms	Radial		Radial	
Hydraulic Pressure	3,000 PSI		3,000 PSI	
Hydraulic Flow	Traction: 16.9 gpm (each pump); Auxiliary: 13.8 gpm		Traction: 16.9 gpm (each pump); Auxiliary: 11.4 gpm	
Reservoir Capacity	10.5 gallons (40 liters)		10.5 gallons (40 liters)	
Tracks	Sprocket-drive, 10 road wheels per side		Sprocket-drive, 10 road wheels per side	
Traction	Dual hydrostatic pump			
Track Length	96.6" x 5.9" (245 cm x 15 cm)	96.6" x 9.5" (245 cm x 24 cm)	96.6" x 5.9" (245 cm x 15 cm)	96.6" x 9.5" (245 cm x 24 cm)
Ground Pressure	5.0 PSI	3.5 PSI	5.0 PSI	3.5 PSI

* Per ISO 14397-1
** Per SAE 1995

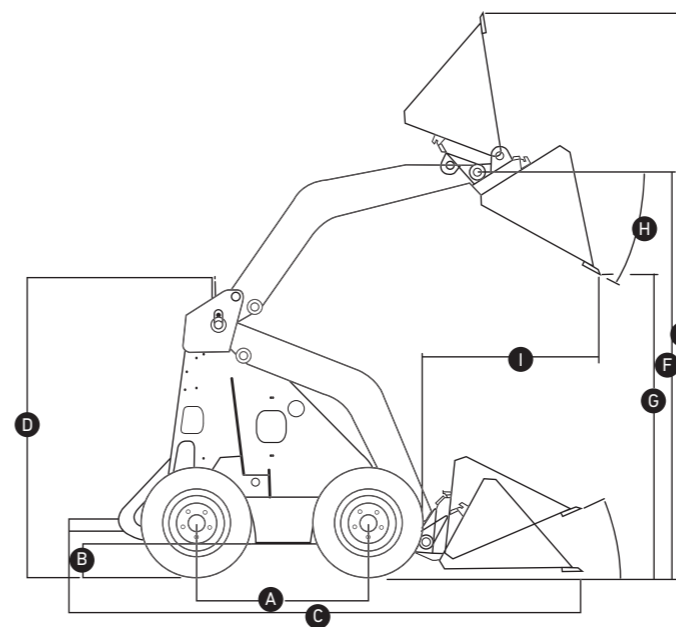
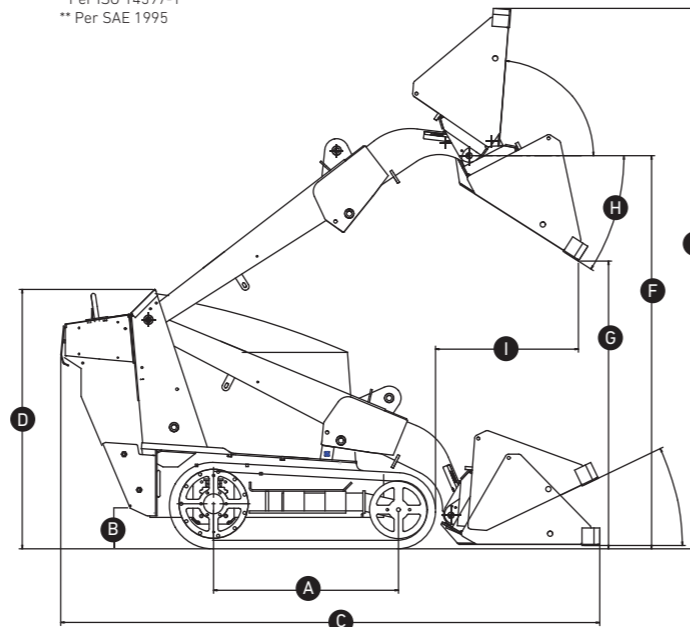

DINGO 220, 323 & 320-D SPECIFICATIONS

	DINGO 220 22317	DINGO 323 22318	DINGO 320-D 22337CP
A Wheelbase	28" (71 cm)		
B Ground Clearance	5.8" (15 cm) front & rear		
Overall Width	40.5" (103 cm) standard tires; 35" (90 cm) narrow tires		
C Overall Length	82.2" (208.8 cm) w/bucket; 62" (157.5 cm) w/o bucket		
D Overall Height	48.7" (123.7 cm)		
E Max Operating Height	91.2" (231.6 cm)		
F Hinge Pin Height	66" (167.6 cm)		
G Dump Height	47" (119 cm)		
H Dump Angle	34-degrees		
I Reach - Fully Raised	28" (71.1 cm)		
Ground Speed (F/R)	0-3.7 mph (0-6 km/h) / 0-3.7 mph (0-6 km/h)		0-3.0 mph (0-4.8 km/h) / 0-3.0 mph (0-4.8 km/h)
Weight	1,430 lbs (649 kg)	1,567 lbs (711 kg)	1,722 lbs (781 kg)
Tip Capacity	1,030 lbs (467 kg)		1,048 lbs (466 kg)
Rated Operating Capacity (50% of Tip Capacity)*	515 lbs. (234 kg)		524 lbs. (238 kg)
Engine	Kohler® Command Series CH20	Kohler® Command Series CH23	Kubota D722
Manufacturer's Gross HP Rating at RPM*	20 HP (14.9 kW) @ 3600 rpm	23 HP (17.2 kW) @ 3600 rpm	20 HP (14.9 kW) @ 3600 rpm
Displacement	38.1 cu. in. (624 cc)	41 cu. in. (674cc)	43.88 cu. in. (719 cc)
Fuel Type	Gas		Diesel
Air Filter	High-capacity, paper type w/pre-cleaner	Two-stage, heavy-duty, remote	
Cooling System	Air Cooled		Liquid Cooled
Fuel Tank	5.6 gallon (21 liter)	11.2 gallon (42.4 liter)	4 gallon (15 liter)
Oil Capacity	2 quarts (1.9 liter)		3.4 quarts (3.2 liter)
Loader Arms	Radial		
Hydraulic Pressure	3,250 PSI		
Hydraulic Flow	10.8 gpm high-flow hydraulic circuit, 4 gpm low-flow hydraulic circuit		
Reservoir Capacity	14.8 gallons (56 liter)	17 gallons (64 liter)	14.8 gallons (56 liter)

* Per ISO 14397-1
** Per SAE 1995

DIMENSIONS

- A** Wheelbase
- B** Ground Clearance
- C** Overall Length
- D** Overall Height
- E** Maximum Operating Height
- F** Hinge Pin Height
- G** Dump Height
- H** Dump Angle
- I** Reach